

INSTALLATION INSTRUCTIONS

57i-6505

Peugeot

206

Jan '99

2000cc 16v GTi

TOOLS NEEDED:

Flat Blade Screwdriver
Socket Extension
4mm Allen Wrench
Ratchet
10mm Socket
Pair of Diag. Cutters
Pair of Pliers

PARTS LIST:

A Hose Clamp #44	1	F Hose Clamp #64	1	K Washer 1/4"ID x 5/8"OD	3	P Bolt 6mm - 1.00 x 25mm	1	U Rubber C/Air Duct	1
B Silicone Hose	1	G Filtercharger ® Element	1	L Nut 6mm Nylock Hex	2	Q Z-Bracket	1	V Cable Ties	3
C Hose Clamp #48	1	H Edge Trim	1	M Rubber Mounted Stud	1	R Flexi Cold Air Hose	1		
D Intake Tube	1	I Spacer; 1"ID x 5/8"OD	1	N Hose End	1	S Washer 1.25D x .28Hol	2		
E Filter Adapter	1	J Bracket	1	O Heat Shield	1	T Bolt 6mm -1.00 x 20mm	1		

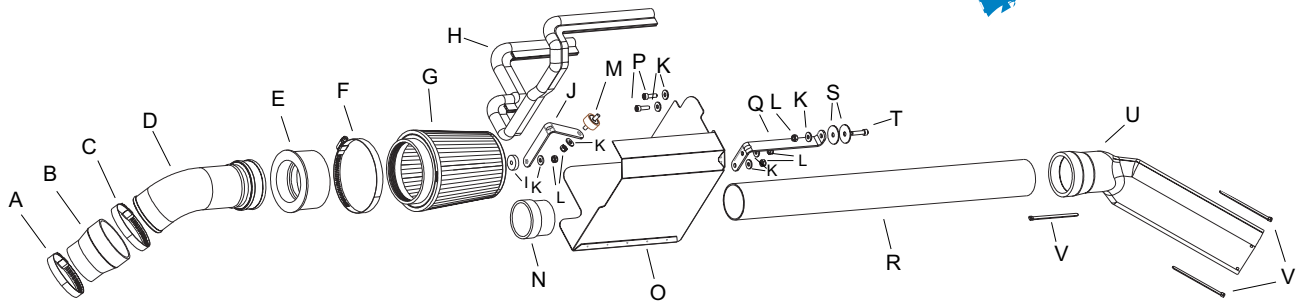

TO START:

1. Turn the ignition OFF and disconnect the vehicle's negative battery cable.



2. Unclip & remove the flexi intake hose from the plastic housing.



3. Carefully lift the complete air box assembly out of its mounting rubbers & remove the assembly from the car.



4. Fit the new 'S' shaped bracket to the original air box mounting point using the long allen head bolt, large washers, nylock nut & small washer.



5. Remove the bolt securing the air box support frame to the chassis leg, replace the bolt with the studded rubber mounting supplied.



6. Attach the new angled bracket to the studded rubber mounting using a nylock nut & small washer.



7. Clip the edge trim to outside edge of the heat shield as shown.



8. Attach the heat shield to the 'S' shaped bracket using the short allen head bolts, nylock nuts & washers supplied.



9. Carefully expand the flexi cold air hose, remove one of the plastic hose ends & insert the hose through the hole in the heat shield. Feed the hose down to the lower spoiler.



10. Fit the stepped silicon hose & rubber filter adapter onto new intake pipe. Fit the new Filtercharger to the intake pipe / filter adapter, fully tighten the hose clips supplied.



11. Ovalise the end of the stepped silicon hose on the new intake assembly & fit it to the original plastic intake housing using a #44 hose clip supplied.



12. Attach the studded lid of the filtercharger to the new mounting bracket using a nylock nut & flat washer supplied.



13. Taking all necessary safety precautions as per manufacturers instructions raise the front of the vehicle. Drill / pierce two small holes in the front lower spoiler trim & radiator lower cross member. Secure the new rubber scoop to the lower spoiler & cross member using the plastic ties supplied (Take care not to damage the radiator). Insert the flexi cold air hose into the base of the rubber scoop.

14. Carry out a final check of the height / alignment of the K&N induction system before starting the engine. Installation is now complete.

15. Reconnect the vehicle's negative battery cable. Double check to make sure everything is tight and properly positioned before starting the vehicle.

16. It will be necessary for all FIPK's to be checked periodically for realignment, clearance and tightening of all connections. Failure to follow the above instructions or proper maintenance may void warranty.

ROAD TESTING:

1. Start the engine with the transmission in neutral or park, and the parking brake engaged. Listen for air leaks or odd noises. For air leaks secure hoses and connections. For odd noises, find cause and repair before proceeding. This kit will function identically to the factory system except for being louder and much more responsive.

2. Test drive the vehicle. Listen for odd noises or rattles and fix as necessary.

3. If road test is fine, you can now enjoy the added power and performance from your kit.

4. K&N suggests checking the Filtercharger element periodically for excessive dirt build-up. When the element becomes covered in dirt (or once a year), service it according to the instructions on the Recharger service kit that is included in this kit.